

# DeltaBoard Fixing Dowels

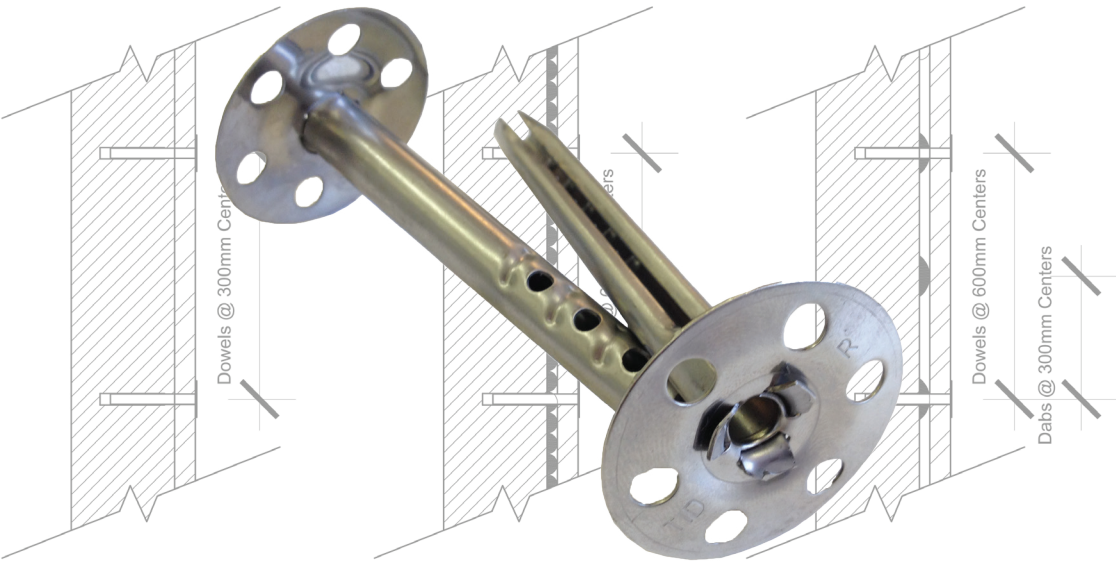

## INSULATION SUPPORT ANCHOR HAMMER SET TUBULAR BODIED ANCHOR

FOR - MECHANICAL FIXING OF **DeltaBoard**

ONTO - CONCRETE, CONCRETE BLOCKWORK AND BRICKWORK

### FEATURES

- Cylindrical carbon/stainless anchor with 35mm washer face
- available in aluzinc coated carbon steel and A2 stainless steel
  - one-piece fastener
  - reduced on-site costs
- Simple installation: hammer-in into pre-drilled hole
  - wide range of lengths from 80 - 250mm

### APPLICATION DETAIL

• HOLE DIAMETER:	8MM
• EMBEDMENT:	50MM
• HOLE DEPTH:	60MM
• MINIMUM APPLICATION TEMPERATURE:	5°C
• DELTABOARD THICKNESS = ANCHOR LENGTH - EMBEDMENT - ADHESIVE BED (OPTIONAL)	

# DeltaBoard Fixing Dowels



**NOTE:** THE DOWEL SHANK MUST BE EMBEDDED INTO THE SUPPORTING MASONRY BY NO LESS THAN 50MM.

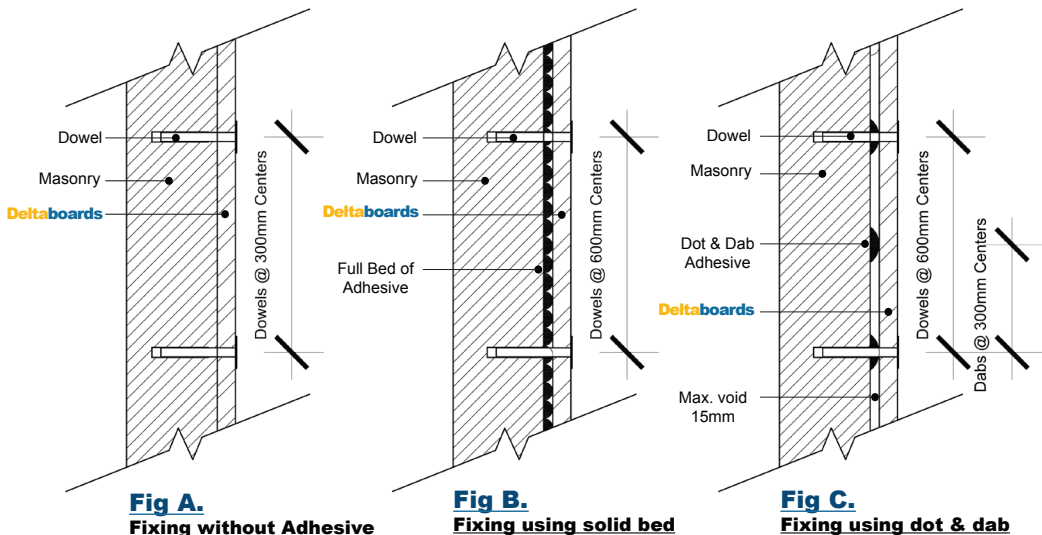

## **FIXING DELTABOARD USING DOWELS (NO ADHESIVE) FIG A:**

Fix Dowels at 300mm centres

## **FIXING DELTABOARD USING ADHESIVE AND DOWELS (SOLID BED METHOD) FIG B:**

Prepare and prime substrate. Using a good quality rapid set Flexible Cement Based Tile Adhesive, apply the adhesive to the masonry using a thick bed notched tiling trowel and fit the DeltaBoard firmly into the adhesive. With the DeltaBoard positioned correctly the Dowels can be fitted at a distance of 600mm centres.

## **FIXING DELTABOARD USING ADHESIVE AND DOWELS (DOT AND DAB METHOD) FIG C:**

Prepare and prime substrate. Using a good quality rapid set Flexible Cement based Tile Adhesive, apply the adhesive dabs directly onto the surface of the DeltaBoard at minimum distance of 300mm centres. Place the DeltaBoard firmly onto the masonry wall and apply moderate force so that the dabs of adhesive bond to the substrate. It is very important that the adhesive dabs are compressed into the masonry wall resulting in a dab thickness of less than 15mm. It is important to ensure that the remaining void between the wall and the bonded face of the DeltaBoard is therefore no greater than 15mm. Adhesive dabs that are greater than 15mm can shrink and crack and could result in failed adhesion of the board surface. When using Dot and Dab method it is important to allow the adhesive dabs to harden before fixing the Dowels. Once the adhesive has set, the Dowels can be fitted at a distance of 600mm centres. The Dowels must be fitted directly through the DeltaBoard and through the adhesive dabs.

## **NOTE:**

All information is given as guidance and if adhered to the products will perform as intended. We fully guarantee the quality of our boards but as we do not have knowledge of site conditions or the capability of the installer, we cannot accept liability for damage which may arise as a result of installation.