

# Delta Raising Plinths



DeltaTrays used with Delta Raising Plinth provide the perfect solution for rooms with concrete floors or rooms that have restricted waste pipe routes. Installing DeltaTray combined with the special pre machined raising plinth, into which the drain body and the waste pipe can be routed, will overcome many installation restrictions. The final result is a raised showering area with stunning appeal.

DeltaTrays used in conjunction with Delta Raising Plinths are used to create stylish raised tileable shower areas in rooms where the drain assembly cannot be situated under the floor. It may be that you do not wish to excavate a concrete floor, there may be floor joists that conflict with the drain location or you simply want to create a stylish raised shower platform.



## The advantages of a Raised Platform Wetroom:

- ✓ Labour saving shower solution ideal for concrete floors.
- ✓ Easily cut down to size.
- ✓ Excellent surface to tile.
- ✓ Lightweight & Waterproof.
- ✓ Compatible for use with underfloor heating.
- ✓ Versatile to suit your design requirements.

### Technical Data (Refer to Building Regulations for product compatibility)

Properties <small>(data refers to the XPS core)</small>	Value
Compressive Strength (10% deformation) BSEN 826	300 kPa
Thermal Conductivity to BSEN 13164	0.036 W/mK
Water Absorption by Immersion EN12087	≤ 1.5%
Temperature Range	-50°C, + 75°C
Fire Performance EN 13501-1	Euroclass E



## Typical Floor Selection

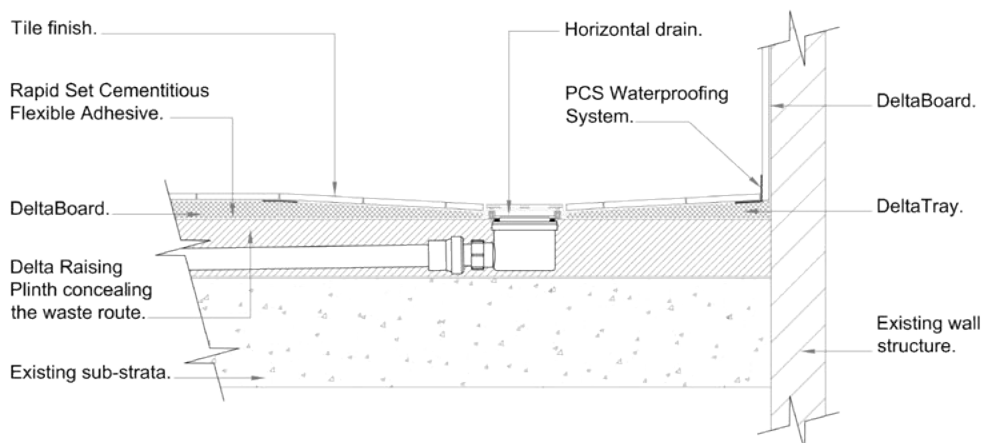

## DeltaTray Thames Centre & Offset Plinths

Product ID	Size (W x Hmm)	Thickness	Drain Position
E0011	800 x 800mm	100mm Plinth	Centre Drain
E0021	900 x 900mm	100mm Plinth	Centre Drain
E0031	1000 x 1000mm	100mm Plinth	Centre Drain
E0041	1200 x 1200mm	100mm Plinth	Centre Drain
E0078	900 x 1200mm	100mm Plinth	Centre Drain
E0051	1500 x 1500mm	100mm Plinth	Centre Drain
E0103	900 x 1500mm	100mm Plinth	Centre Drain
E0116	900 x 1800mm	100mm Plinth	Centre Drain
E0061	1000 x 1000mm	100mm Plinth	Offset Drain
E0071	800 x 1200mm	100mm Plinth	Offset Drain
E0079	900 x 1200mm	100mm Plinth	Offset Drain
E0081	1200 x 1000mm	100mm Plinth	Offset Drain
E0091	1200 x 1200mm	100mm Plinth	Offset Drain
E0101	800 x 1500mm	100mm Plinth	Offset Drain
E0106	900 x 1600mm	100mm Plinth	Offset Drain
E0121	900 x 1800mm	100mm Plinth	Offset Drain

## DeltaTray Trent Linear Plinths

Product ID	Size (W x Hmm)	Thickness	Drain Position
E0511	900 x 1200mm	100mm Plinth	Linear Offset Drain (END)
E0516	900 x 1500mm	100mm Plinth	Linear Offset Drain (END)
E0521	900 x 1500mm	100mm Plinth	Linear Offset Drain (SIDE)
E0531	1000 x 1800mm	100mm Plinth	Linear Offset Drain (END)

• Raising plinths are manufactured to order & require 10 days lead time.

- ★ Labour saving shower solution ideal for concrete floors
- ★ Lightweight
- ★ Easily cut down to size
- ★ Compatible for use with underfloor heating
- ★ Waterproof
- ★ Versatile to suit your design requirements

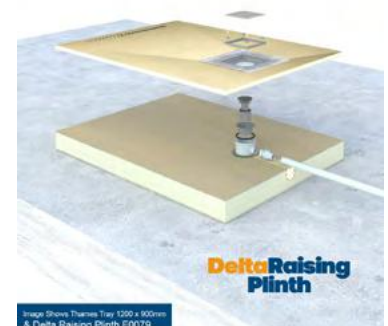
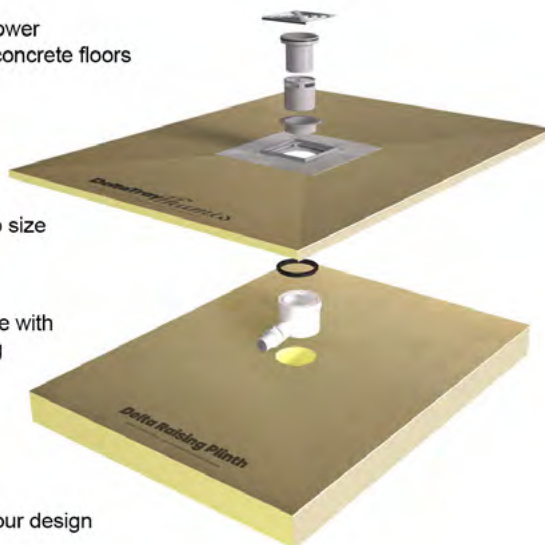

Image Shows Thames Tray 1200 x 900mm & Delta Raising Plinth E0079



Image Shows Trent Tray 1800 x 1000mm & Delta Raising Plinth E0531